

Description

TELAIO DD2 MOD. FALCON  
DD2 CHASSIS MOD. FALCON

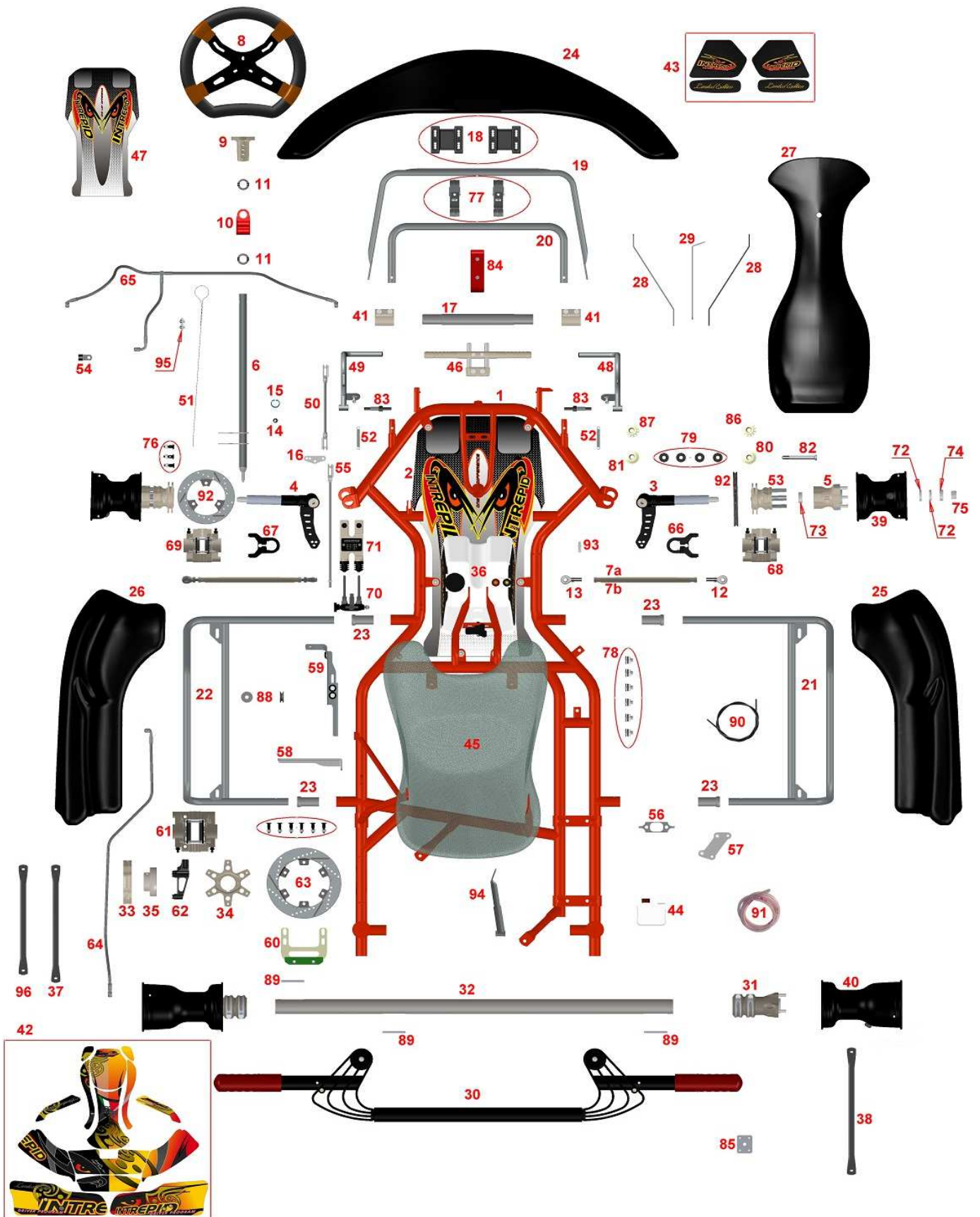

Pos.	Code	Description
1	I/DD2/FAL/30	SCOCCA MOD. FALCON DD2 Ø30/32mm FRAME MOD. FALCON DD2 Ø30/32mm
2	I/INT0694-06	PIANALE MOD. RACING RACING FLOOR PLATE
3	I/INT1161SHNDX-15	FUSELLO DX Ø25mm 10,25° - H1 - NERO - MOD. 2015 RIGHT SPINDLE Ø25mm 10,25° - H1 - BLACK - MOD. 2015
4	I/INT1161SHNSX-15	FUSELLO SX Ø25mm 10,25° - H1 - NERO - MOD. 2015 LEFT SPINDLE Ø25mm 10,25° - H1 - BLACK - MOD. 2015
5	I/INT1064L75-15	MOZZO ANTERIORE L.75mm - UNIVERSALE cuscinetto Ø25mm - 2015 FRONT HUBS L.75mm - STANDARD bearing Ø25mm - 2015
6	I/INT1039-15	PIANTONE STERZO L. 490MM - MOD. 2015 STEERING COLUMN L. 490mm - MOD. 2015
7	I/INT0983-15	BARRETTA STERZO L.282mm TITAN-GOLD (SIRIUS) TIE ROD L.282mm TITAN GOLD (SIRIUS)
8	I/INT0144-05	VOLANTE 4 RAZZE Ø330mm - MOD. RACE UNIVERSALE STEERING WHEEL WITH 4 SPOKES Ø330mm - MOD. RACE UNIVERSAL
9	I/ST052TG-08	MOZZO VOLANTE INCLINATO KF/KZ- 3 FORI - TITAN-GOLD KF/KZ INCLINED STEERING WHEEL HUB - 3 HOLES - TITAN-GOLD
10	I/ST079RS-05	SUPPORTO PER PIANTONE STERZO - NYLON - 2FORI - ROSSO STEERING COLUMN SUPPORT - NYLON - 2 HOLES - RED
11	I/ST001TG-08	ANELLO DI FERMO PIANTONE COMPLETO DI GRANI - TITAN-GOLD STEERING LOCKING COLUMN BUSH TITAN GOLD
12	I/ST110DX-05	UNIBALL M8 DX - AC RIGHT UNIBALL M8 - AC
13	I/ST110SX-05	UNIBALL M8 - SX - AC LEFT UNIBALL M8 - AC
14	I/ST046-05	UNIBALL PIANTONE STERZO PB8 UNIBALL FOR STEERING COLUMN PB8
15	I/ST051-05	SEEGER Ø22mm PER UNIBALL PIANTONE STERZO SNAP RING Ø22mm FOR STEERING COLUMN UNIBALL
16	I/LAMATF	LAMA RINVIO TIRANTE FRENO BLADE FOR BRAKE TIE ROD
17	I/INT0970-07	BARRA STABILIZZATRICE Ø28mm ANT. - NYLON NYLON FRONT STABILIZER ROD Ø28mm
18	I/AFS.00036	PLACCA FISSAGGIO SPOILER ANT. NA2 (2 PZ.) FASTENING PLAC FOR FRONT SPOILER NA2 (2 PZ.)
19	I/INTPASNA2	PARAURTI ANTERIORE SUPERIORE MOD. NA2 - CROMATO HIGHT FRONT BUMPER MOD. NA2 - CHROMIUM PLATED
20	I/INTPAINA2	PARAURTI ANTERIORE INFERIORE MOD. NA2 - CROMATO LOW FRONT BUMPER MOD. NA2 - CHROMIUM PLATED
21	I/SCO.0095D	SUPPORTO PARAURTI LAT. NA2 DX RIGHT BODYWORK SUPPORT NA2
22	I/SCO.0095S	SUPPORTO PARAURTI LAT. NA2 SX LEFT BODYWORK SUPPORT NA2
23	I/INT0662-06	BOCCOLA IN TEFLON PER ATTACCO PARAURTI LATERALE FASTENING WASHER IN TEFLON FOR LATERAL BUMPER
24	I/AFS.01617	SPOILER ANTERIORE NA2 - NERO FRONT SPOILER NA2 BLACK
25	I/AFS.1618D	CARENATURA LATERALE NA2 DX - NERO RIGHT SIDE BODYWORK NA2 - BLACK
26	I/AFS.1618S	CARENATURA LATERALE NA2 SX - NERO LEFT SIDE BODYWORK NA2 - BLACK
27	I/AFS.01616	FRONTALINO NA2 CIK FIA - NERO NASSAU PANEL NA2 CIK FIA - BLACK
28	I/INT0819-06	COPPIA SUPPORTO SUP. FRONTALINO UPPER COUPLE FOR NUMBER PLATE HOLDER
29	I/INT1009-07	SUPPORTO INFERIORE FRONTALINO LOW SUPPORT FOR NUMBER PLATE HOLDER

Pos.	Code	Description
30	I/AR585-06	PARAURTI POSTERIORE MOD. DD2 DD2 REAR BUMPER
31	I/MZP209TG-09	MOZZO Ø40X125mm - TITAN-GOLD REAR HUB Ø40X125mm - TITAN GOLD
32	I/AX059-06	ASSALE FORATO Ø40X1040mm - MOD. DD2- TIPO B HOLED AXLE Ø40X1040mm - MOD. DD2 - TYPE B
33	I/INT1035-15	GUSCIO PORTACUSCINETTO Ø40-50mm - TITAN-GOLD MOD. 2015 BEARING BUSH SUPPORT Ø40-50mm -TITAN-GOLD MOD. 2015
34	I/INT1082-15	PORTADISCO Ø40mm TITAN-GOLD MOD. 2015 DISC SUPPORT Ø40mm TITAN-GOLD MOD. 2015
35	I/CU004-05	CUSCINETTO PER ASSALE Ø40mm BEARING FOR AXLE Ø40mm
36	I/AR277-05-KZ	SERBATOIO KZ 8,5L COMPLETO KZ TANK L8,5 COMPLETE
37	I/AR754-09	RINFORZO SEDILE TONDO L.300mm - CROMATO L.300mm ROUND SEAT SUPPORT - CHROMIUM PLATED
38	I/AR755-09	RINFORZO SEDILE TONDO L.320mm - CROMATO CHROMED ROUND SEAT SUPPORT L.320mm
39	I/CE104MG-10	CERCHIO ANTERIORE L.132 CON FORI - LINEA MAGNESIO MAGNESIUM FRONT RIMS Ø132 WITH HOLES - MAGNESIUM LINE
40	I/CE103MG-10	CERCHIO POSTERIORE L.212 CON FORI - LINEA MAGNESIO MAGNESIUM REAR WHEEL RIM H212mm WITH HOLES - MAGNESIUM LINE
41	I/AR197ALTG-08	FASCETTA STRINGITUBO Ø28mm - AL - TITAN-GOLD TIGHTENING PIPE BELT Ø28mm - AL - TITAN-GOLD
42	I/INT1129-08-NA2	KIT ADESIVI CARENATURE NA2 NA2 COMPLETE STICKERS KIT
43	I/INT1130-08	KIT ADESIVI SERBATOIO STICKERS KIT FOR FUEL TANK
44	I/INT2013-09	SERBATOIO DI RECUPERO RECOVER TANK
45	I/INT0896-06	SEDILE MOD. RACING SILVER SEAT MOD. RACING SILVER
46	I/INT0992-07	SISTEMA POGGIPIEDI REGISTRABILE ADJUSTABLE FOOTREST SYSTEM
47	I/INT0971-07	ADESIVO INTREPID PER PIANALE STICKER FOR FLOOR PLATE
48	I/INT0967-07	PEDALE ACCELERATORE - CROMATO CHROMED ACCELERATOR PEDAL
49	I/INT0968-07	PEDALE FRENO - CROMATO CHROMED BRAKE PEDAL
50	I/TFM6P	TIRANTE FRENO LATO PEDALE M6 BRAKE TIE ROD M6 FOR PEDAL
51	I/FR105-05	CAVO DI SICUREZZA L.350mm - MINI/KZ/DD2 SAFETY STEEL CABLE L. 350mm - MINI/KZ/DD2
52	I/AR093-05	MOLLA PEDALE ZINCATA PEDAL SPRING - GALVANIZED
53	I/INT1065-15	PORTA DISCO ANTERIORE KZ - R2/R1K TITAN-GOLD FRONT DISC SUPPORT KZ - R2/R1K TITAN-GOLD
54	I/FR097-05	FASCETTA FISSAGGIO TUBO FRENO - Ø8mm BRAKE PIPE FIXING BELT - Ø8mm
55	I/FR340-KZ	KIT COMPLETO TIRANTE FRENO KZ - M6X340 CHROMED TIE ROD KZ - M6X340
56	I/PM090-15	SPESSORE 2,5mm PER CAVALLOTTO DD2 LINING FOR BRAKET 2,5mm MOD. DD2
57	I/AR666-06	KIT SUPPORTO POMPA BENZINA Ø32 MOD. DD2 BRAKE PUMP SUPPORT KIT MOD. DD2 Ø32
58	I/GT050-06	LAMA SUPPORTO RADIATORE INFERIORE MOD. DD2 DD2 LOW RADIATOR PLATE SUPPORT

Pos.	Code	Description
59	I/GT051-06	LAMA SUPPORTO RADIATORE SUPERIORE MOD. DD2 DD2 HIGH RADIATOR PLATE SUPPORT
60	I/INT1135-09	PROTEZIONE DISCO FRENO POSTERIORE REAR BRAKE DISK PROTECTOR KIT
61	I/PFP-R1/2K	PINZA FRENO POSTERIORE R1K/R2K REAR BRAKE CALIPER R1K/R2K
62	I/SPP-R1/R2K	SUPPORTO PINZA POSTERIORE R1K/R2K - AL- NERO REAR BRAKE CALIPER SUPPORT R1K/R2K - AL- BLACK
63	I/DFP-R1/R2K	DISCO FRENO POSTERIORE R1K/R2K/R1/R2 REAR BRAKE DISC R1K/R2K/R1/R2
64	I/KITFR-P	KIT TUBO FRENO POST. R1K/R2K REAR BRAKE PIPE R1K/R2K
65	I/KITFR-R1K4WP	KIT TUBO FRENO ANTERIORE R1K 4WP 82/FR/20 FRONT BRAKE PIPE R1K 4WP 82/FR/20
66	I/SPADX-R1K	SUPPORTO PINZA ANT. DX R2/R1K 4WP - NERO FRONT CALIPER PLATE SUPPORT R2/R1K 4WP - RIGHT - BLACK
67	I/SPASX-R1K	SUPPORTO PINZA ANT. SX R2/R1K 4WP - NERO FRONT CALIPER PLATE SUPPORT R2 - LEFT - BLACK
68	I/PFAR1KDX-4WP	PINZA FRENO ANTERIORE DX R1K 4WP 82/FR/20 RIGHT FRONT BRAKE CALIPER R1K 4WP 82/FR/20
69	I/PFAR1KSX-4WP	PINZA FRENO ANTERIORE SX R1K 4WP 82/FR/20 LEFT FRONT BRAKE CALIPER R1K 4WP 82/FR/20
70	I/RIPFR1K-4WP	RIPARTITORE DI FRENATA R1K-4WP R1K-4WP BRAKING DISTRIBUTION
71	I/PF17-20	POMPA FRENO DOPPIO CORPO Ø17mm R1K/R2K R1K/R2K BRAKE PUMP Ø17mm WITH DOUBLE BODY
72	I/FS036-06	SPESSORE FUSELLO Ø25X6mm - GIALLO SPINDLE LINING Ø25X6mm - YELLOW
73	I/FS037-06	SPESSORE FUSELLO Ø25X10mm - GIALLO SPINDLE LINING Ø25X10mm - YELLOW
74	I/FS038-06	RONDELLA Ø25mm PER CHIUSURA MOZZO STEEL WASHER Ø25mm FOR HUB LOCKING
75	I/FS008-05	DADO M14X1,5mm AUTOBLOCCANTE SELFLOCKING NUT M14X1,5mm
76	I/INT1092-15	KIT BOCCOLE FLOTTANTI PORTADISCO ANT. R1K (3 PZ) DISC SUPPORT R1K COMPLETE FLOATING BUSH KIT (3 PZ)
77	I/INT2013-01	KIT GANCI ATTACCO SPOILER ANTERIORE 2 PZ. CLAMP KIT FOR FRONT SPOILER 2 PZ.
78	I/INT2013-03	KIT VITI CON GOMMINO PER FISSAGGIO PIANALE 6 PZ. SCREW KIT WITH RUBBER WASHER FOR FLOOR PLATE 6 PZ.
79	I/INT0734-06	RONDELLA PER REGOLAZIONE FUSELLO Ø10 HIGH REGULATION SPINDLE WASHER Ø10
80	I/INT0956-07	BOCCOLA DRITTA SUPERIORE UPPER STRAIGHT BUSH
81	I/INT0957-07	BOCCOLA DRITTA INFERIORE LOWER STRAIGHT BUSH
82	I/INT0794-06	VITE FUSELLO Ø10 - SPECIALE RETTIFICATA SPINDLE SCREW Ø10 - SPECIAL WITH GRINDING
83	I/INT2013-04	VITE ATTACCO PEDALE PEDAL'S SREW
84	I/INT2013-05	COPPIA FISSAGGIO PARAURTI ANT. - PLASTICA - ROSSA 2 PZ. COUPLE OF JOINTS FOR FRONT SPOILER - PLASTIC - RED 2 PZ.
85	I/INT2013-07	PIASTRINA ATTACCO SEDILE - ALLUMINIO SEAT'S PLATE CONNECTION - ALUMINIUM
86	I/INT1010-07	BOCCOLA ECCENTRICA SUPERIORE 1° - GIALLA UPPER HEAD ECCENTRIC BUSH 1° - YELLOW
87	I/INT1011-07	BOCCOLA ECCENTRICA INFERIORE 1° - GIALLA LOWER HEAD ECCENTRIC BUSH 1° - YELLOW

Pos.	Code	Description
88	I/AR216TG-05	SPESSORE SEDILE Ø30XØ10X10mm - ALLUMINIO SEAT LINING Ø30XØ10X10mm - ALUMINIUM
89	I/CH005-05	CHIAVETTA 8X5X60mm KEY 8X5X60mm
90	I/AR140NR-05	GUAINA PER CAVO ACCELERATORE - COL. NERO ACCELERATOR SHEATH WIRE - BLACK
91	I/AR078-05	TUBO BENZINA Ø5X10mm - MT. 1 FUEL PIPE - Ø6X9mm - EACH METER
92	I/DFA-R1K-4WP	DISCO FRENO ANTERIORE R2/R1K 4WP FRONT BRAKE DISC R2/R1K 4WP
93	I/AR137-05	REGISTRO M6X30mm PER GUAINA M6X30mm REGISTER FOR SHEATH
94	I/SUPDX-DD2	SUPPORTO SEDILE DX MOD. DD2 RIGHT SEAT SUPPORT MOD. DD2
95	I/AR487-05	MORSETTO A 2 VITI PER CAVO ACCELERATORE 2 SCREW CLAMP FOR ACCELERATOR AND CLUTCH WIRE
96	I/AR753-09	RINFORZO SEDILE TONDO L.280mm- CROMATO L.280mm ROUND SEAT SUPPORT - CHROMIUM PLATED